

# HEINNER

## OIL FILLED RADIATOR

Model: HOH-YV13BK



- Oil filled radiator
- Rated Frequency: 220-240 V~, 50/60Hz
- Power: 2900W

**Thank you for purchasing this product!**

## I. INTRODUCTION

***Before using the appliance, please read carefully this instruction manual and keep it for future reference.***

This instruction manual is designed to provide you with all required instructions related to the installation, use and maintenance of the appliance.

In order to operate the unit correctly and safety, please read this instruction manual carefully before installation and usage.

## II. YOUR PACKAGE CONTAINS



- **Oil Filled Radiator**
- **User manual**
- **Warranty card**

**This product is only suitable for well insulated spaces or occasional use!**

### III. SAFETY MEASURES

1. Read all instructions carefully before using.
2. Make sure the voltage is the same as that indicated on the rating plate of the appliance.
3. Do not operate this appliance if the cable or plug becomes damaged.
4. Keep the appliance and cable away from sources of heat, sharp objects or anything that may cause damage.
5. If the cord is damaged, it must be replaced by the manufacturer, its service agent or similarly qualified persons in order to avoid a hazard.
6. Ensure the appliance is switched off before connecting to the mains power supply.
7. Switch off the power supply and disconnect from mains supply when not in use, before cleaning or other maintenance.
8. To disconnect the appliance, switch it "OFF", and then remove the plug from outlet. Do not pull the cord to disconnect the plug.
9. The heater must not be located immediately below a socket-outlet.
10. Do not operate in areas where gasoline, paint or other flammable liquids are used or stored.
11. Indoor use only.
12. In order to avoid overheating, do not cover the heater.
13. To prevent a possible fire, do not block air intakes or exhaust in any manner.
14. Don't touch the hot surfaces.
15. Do not insert or allow foreign objects to enter any ventilation or exhaust opening, as this may cause an electric shock, fire or damage to the appliance.
16. Always ensure that hands are dry before operating or adjusting any switch on the product or touching the plug and socket-outlet.
17. The appliance can be used by children aged from 8 years and above and persons with reduced physical, sensory or mental capabilities or lack of experience and knowledge if they have been given supervision or instruction concerning use of the appliance in a safe way and understand the hazards involved.
18. Children shall not play with the appliance. Cleaning and user maintenance shall not be made by children without supervision.

19. Children of less than 3 years should be kept away unless continuously supervised.
20. Children aged from 3 years and less than 8 years shall only switch on/off the appliance provided that it has been placed or installed in its intended normal operating position and they have been given supervision or instruction concerning use of the appliance in a safe way and understand the hazards involved. Children aged from 3 years and less than 8 years shall not plug in, regulate and clean the appliance or perform user maintenance.

**CAUTION** – Some parts of this product can become very hot and cause burns. Particular attention has to be given where children and vulnerable people are present.

21. Do not leave this appliance unattended when it's in use.
22. The most common cause of overheating is deposits of dust or fluff in the appliance. Ensure these deposits are removed regularly by disconnect the appliance and vacuum cleaning air vents and grilles.
23. Do not place the heater on carpet, don't place the cable under carpets. Arrange cord away from traffic areas so that it will not be tripped over.
24. Do not use this heater in the immediate surroundings of a bath, a shower or a swimming pool.
25. Do not store away until the heater cools down, store the heater in cool dry location when not in use.
26. This heater is filled with a precise quantity of special oil. Repairs requiring opening of the oil container are only to be made by the manufacturer or his service agent who should be contacted if there is an oil leak
27. When scrapping the heater, follow the regulations concerning the disposal of oil.

## IV. PRODUCT DESCRIPTION

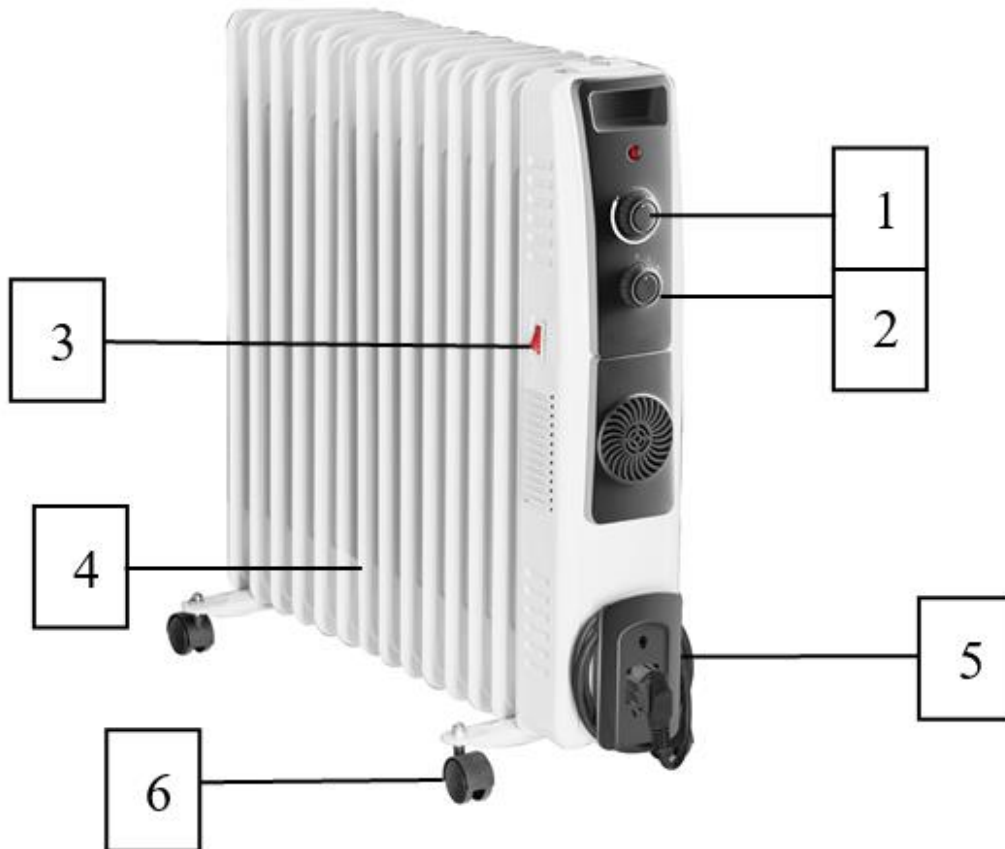

<b>1. Thermostat knob</b>	<b>4. Radiant fins</b>
<b>2. Power switch</b>	<b>5. Cord storage</b>
<b>3. Fan switch</b>	<b>6. Castor</b>

## V. ASSEMBLY

The heater is packaged with the feet unattached. You must attach them before operating the heater.

**WARNING: Do not operate without feet attached. Do operate the heater only in upright position (feet on the bottom, controls on the top), any other position could create a hazardous situation.**

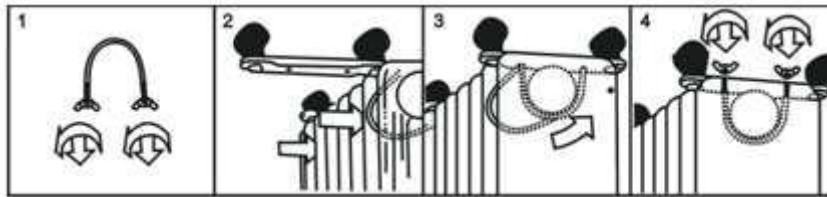

1. Place the radiator body upside-down on a scratch-free location, make sure it is stable and will not fall.

2. Screw off the wing nuts from the U-shaped bolt provided (see Fig 1), attach the U-shaped bolt to the U-facing flange between first and second fins (near the front cover)(see Fig 2).

3. To attach the castor mounting plate to the radiator body, you should insert the threaded ends of the U bolt in the holes on the castor mounting plate (see Fig 3).

4. Screw the front wing nut to the front screw , same way , screw the back wing nut to the back screw. ( see Fig .4)

Note: do not over tighten, which may cause the damage of radiator flange.

Note: the rear castors must be mounted between the end two fins.

## VI. USING INSTRUCTIONS

1. Before using the heater, make sure that it is on a flat and stable surface. Damage may occur if it is placed on an incline or decline.
2. Set all the controls to OFF position and insert the plug into a socket-outlet with well grounded. Be sure that plug fits firmly.
3. Rotate the thermostat knob clockwise to MAX position and switch the heater on as follow: the switch I for low heat, the switch II for medium heat and both switches on for high heat.
4. When your room reaches the desired temperature, now slowly rotate the thermostat knob counter clockwise until the pilot light goes out. The thermostat can now be left at this setting. As soon as the room temperature has dropped below the set temperature, the unit will switch it self on automatically until the set temperature has been reached again. In this way the room temperature remains constant with the most economical use of electricity.
5. If you want to change the room temperature setting, rotate the thermostat knob clockwise to raise the temperature, or counter clockwise to lower it.
6. This heater includes an overheat protection system that shuts off the heater when parts of the heater are getting excessively hot.
7. To completely shut the heater off, turn all the controls to OFF, and remove plug from the socket-outlet.
8. Your heater is designed to automatically shut-off when tipped. When returned to normal upright position, heat will automatically come on again. This is a safety feature to avoid possibility of fire should the unit be accidentally upset.

## VII. MAINTENANCE

1. Always remove the plug from the socket-outlet and allow the radiator to cool down before clean the heater.
2. Wipe radiator with a soft damp (not wet) cloth.

**WARNING:**

**Do not immerse the heater in water.**

**Do not use any cleaning chemicals such as detergents and abrasives.**

**Do not allow the interior to get wet as this could create a hazard.**

3. To store away the heater, wind the cable round bobbin and store the heater in a clean dry place.
4. In case of malfunction or doubt, do not try to repair the radiator yourself, it may result in a fire hazard or electric shock.

## VIII. TECHNICAL DATA

<b>Model</b>	<b>HOH-YV13BK</b>
<b>Elements</b>	<b>13 + fan</b>
<b>Rated Voltage</b>	220-240 V~
<b>Rated Frequency</b>	50/60Hz
<b>Rated Power</b>	2900W



## Information requirements for electric local space heaters

Model identifier(s):					
Item	Symbol	Value	Unit	Item	Unit
<b>Heat output</b>				<b>Type of heat input, for electric storage local space heaters only (select one)</b>	
Nominal heat output	$P_{nom}$	2.5	kW	manual heat charge control, with integrated thermostat	[no]
Minimum heat output (indicative)	$P_{min}$	1.0	kW	manual heat charge control with room and/or outdoor temperature feedback	[no]
Maximum continuous heat output	$P_{max,c}$	2.5	kW	electronic heat charge control with room and/or outdoor temperature feedback	[no]
<b>Auxiliary electricity consumption</b>				fan assisted heat output	
At nominal heat output	$eI_{max}$	NA	kW	<b>Type of heat output/room temperature control (select one)</b>	
At minimum heat output	$eI_{min}$	NA	kW	single stage heat output and no room temperature control	[no]
In standby mode	$eI_{SB}$	0	kW	Two or more manual stages, no room temperature control	[no]
				with mechanic thermostat room temperature control	[yes]
				with electronic room temperature control	[no]
				electronic room temperature control plus day timer	[no]
				electronic room temperature control plus week timer	[no]
				<b>Other control options (multiple selections possible)</b>	
				room temperature control, with presence detection	[no]
				room temperature control, with open window detection	[no]
				with distance control option	[no]
				with adaptive start control	[no]
				with working time limitation	[no]
				with black bulb sensor	[no]
Contact details	Please see on the Instruction Manual final page				



**Environment friendly disposal**

You can help protect the environment!

Please remember to respect the local regulations: hand in the non-working electrical equipment's to an appropriate waste disposal center.



**HEINNER** is a registered trademark of **Network One Distribution SRL**. Other brands and product names are trademarks or registered trademarks of their respective holders.

No part of the specifications may be reproduced in any form or by any means or used to make any derivative such as translation, transformation, or adaptation without permission from NETWORK ONE DISTRIBUTION..

Copyright © 2013 Network One Distribution. All rights reserved.

<http://www.heinner.com>, <http://www.nod.ro>



This product is in conformity with norms and standards of European Community

Importer: **Network One Distribution**

Marcel Iancu Street, 3-5, Bucharest, Romania

Tel: +40 21 211 18 56, [www.heinner.ro](http://www.heinner.ro) , [www.nod.ro](http://www.nod.ro)